



## Contents

Important User Information . . . . .	2	Transport and Storage . . . . .	13
Safety Precautions . . . . .	3	Main Beam/Column/Cross Beam Storage Cart . . . . .	13
Pit Filler Stability . . . . .	3	Deck Storage Cart . . . . .	13
Transport and Storage Carts . . . . .	3	Maintenance . . . . .	14
Setting Up for the First Time . . . . .	3	Decks . . . . .	14
Installation . . . . .	4	Drapery Closures . . . . .	14
Review Materials . . . . .	4	Other Preventive Maintenance . . . . .	14
Install First Main Beam . . . . .	4	Replacement Parts . . . . .	15
Assemble First Bay . . . . .	7	Deck . . . . .	15
Continue Adding Bays . . . . .	9	Column Bracket . . . . .	16
Install Accessories . . . . .	9	Beam Brace Bracket . . . . .	16
Disassembly . . . . .	10	Column Foot . . . . .	17
Disassemble Accessories . . . . .	10	Column Brace Bracket . . . . .	17
Disassemble Decks . . . . .	10	Cross Beam . . . . .	18
Loosen Main Beam Anchors . . . . .	11	Cross Beam Socket . . . . .	18
Disconnect Cross Beam Diagonal from Columns . . . . .	11	Anchor Bracket, Stage Edge . . . . .	19
Disassemble the Understructure . . . . .	12	Anchor Bracket, Audience Wall . . . . .	19
		Storage/Transport Cart . . . . .	20



Visit the STRATA Orchestra Pit Filler web page at [wengercorp.com](http://wengercorp.com) for more information.

**Note:** Please read and understand these instructions before proceeding.  
**Note:** If you need additional information, contact Wenger Corporation using the information below.

# ***Important User Information***

---

## ***General***

Copyright © 2024 by Wenger Corporation

All rights reserved. No part of the contents of this manual may be reproduced, copied, or transmitted in any form or by any means including graphic, electronic, or mechanical methods or photocopying, recording, or information storage and retrieval systems without the written permission of the publisher, unless it is for the purchaser's personal use.

Printed and bound in the United States of America.

The information in this manual is subject to change without notice and does not represent a commitment on the part of Wenger Corporation. Wenger Corporation does not assume any responsibility for any errors that may appear in these instructions.

In no event will Wenger Corporation be liable for technical or editorial omissions made herein, nor for direct, indirect, special, incidental, or consequential damages resulting from the use or defect of these instructions. The manufacturer reserves the right to change this product at any time.

The information in this document is not intended to cover all possible conditions and situations that might occur. The end user must exercise caution and common sense when assembling or installing Wenger Corporation products. If any questions or problems arise, call the Wenger Corporation at (800) 4WENGER (493-6437) or +1-507-455-4100 worldwide.

## ***Manufacturer***

The STRATA® Orchestra Pit Filler is manufactured by:

Wenger Corporation  
555 Park Drive  
Owatonna, MN 55060  
(800) 4WENGER (493-6437) • +1 (507) 455-4100  
wengercorp.com

## ***Intended Use***

- This product is designed to be an extension platform for performance groups.
- This product is intended for indoor use in normal ambient temperature and humidity conditions – it must not be exposed to prolonged outside weather conditions.
- This product is intended to be assembled, installed and used only as described in these instructions.

## ***Warranty***

Warranty information is available at [wengercorp.com](http://wengercorp.com).

## Safety Precautions

---

Throughout this document you may find cautions and warnings which are defined as follows:

- **WARNING:** Failure to follow the instruction could result in serious injury or damage to property.
- **CAUTION:** Failure to follow the instruction could result in minor injury or damage to property.

Read and understand all of these safety instructions before any assembly, installation or use.

### **⚠WARNING**

*Make sure anyone assembling, installing or using these products has read and understands these instructions.*

### **⚠WARNING**

*Failure to comply with Warnings and Cautions in this document or on the equipment can result in damage to property or injury.*

### Setup

- Make sure that anyone who helps set up the pit filler is familiar with these instructions.
- Many steps require that two people work together in the setup.

### **⚠WARNING**

*To avoid injury, two people must always lift the beam assembly upward.*

### **⚠WARNING**

*Use of some man lifts is prohibited.  
Please contact Wenger Corporation Customer Service for written certification of the man lift intended to be used.  
Be prepared to provide make and model for consideration.*

### Pit Filler Stability

- All pit filler main beams and cross beams must be connected together using the methods described in these instructions.
- The assembly must comply with the instructions contained in the layout drawings.  
For additional copies, contact Wenger Corporation Customer Service.

### **⚠WARNING**

*Components must be connected as specified in these instructions.*

### Transport and Storage Carts

- Before loading pit filler components onto a cart, always lock the casters on the cart.
- Always secure the decks to the cart after loading to prevent the decks from falling.

### **⚠CAUTION**

*Always lock the casters when loading and unloading the cart.*

## Setting Up for the First Time

---

1. Remove all parts from their shipping cartons (refer to the packing list enclosed with the shipment). Save all packaging materials until the orchestra pit filler has been set up and assembled for the first time.
2. Sort all orchestra pit filler items by size, length, etc.
3. If the orchestra pit filler is to be stored before the initial set up and assembly, go to the *Transport and Store Pit Filler* section.
4. If the pit filler is to be set up immediately, go to "Installation".

### **NOTICE**

*Read and understand this entire manual before starting the assembly.*

---

# Installation

---

## Review Materials

1. Review the owner's packet that contains a layout drawing with instructions relating to the pit filler installation.

### NOTICE

*The numbering scheme on the layout drawing is letters for support structures and numbers for deck components.*

### ⚠ WARNING

*To avoid injury, two people must always set up the pit filler.*

## Install First Main Beam

1. Each end of the main beam has a letter designation beginning with the letter **A**. Refer to the layout drawing to identify which beam and column to assemble first and where in the pit the assembly starts.
2. Attach two columns to the first main beam by first matching the letters on the columns to the letters on the main beam, **A** to **A**, **B** to **B**, and so on. Then, insert a snap lock pin through the hole in each column and column bracket.

### ⚠ WARNING

*Components must be connected as specified in these instructions.*

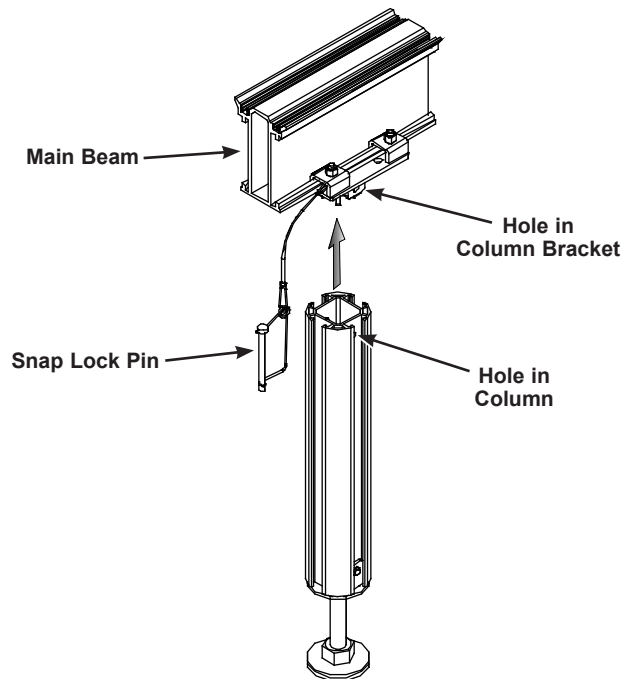

## Installation (continued)

### Install First Main Beam (continued)

3. Connect the main beam diagonal braces to the columns by inserting a tab lock pin through the hole in each column brace bracket and diagonal brace.

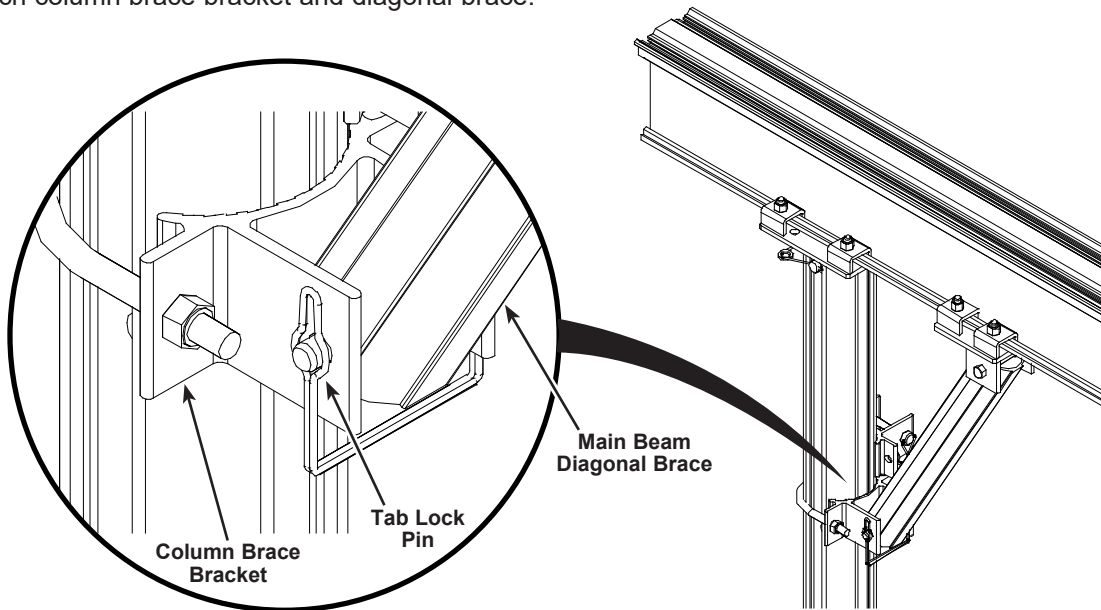

4. With two people working together, tilt the main beam and columns upward. Align the column feet to the marks on the floor to make sure that the assembly is in the correct position.

#### NOTICE

*The beam should be set to the proper elevation and level after the initial Wenger Corporation installation and should not require leveling adjustment.*

#### NOTICE

*Make sure that the stage edge anchor bracket is adjacent to the stage edge and that the audience wall anchor bracket is adjacent to the audience wall.*

#### WARNING

*To avoid injury, two people must always lift the beam assembly upward.*

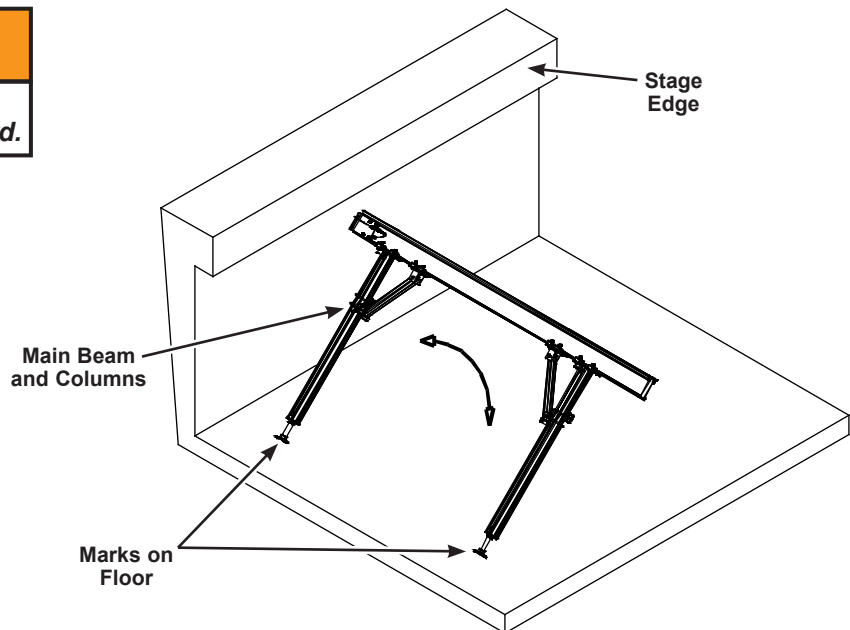

# Installation (continued)

## Install First Main Beam (continued)

5. Insert the anchor bolt through the anchor plate and screw it clockwise into the stage edge or audience wall.  
Do not tighten!

### NOTICE

*The anchor bolt should be tight enough to keep the main beam from falling but allow the beam to shift as other main beams and decks are installed.*

### ⚠ WARNING

*Components must be connected as specified in these instructions.*

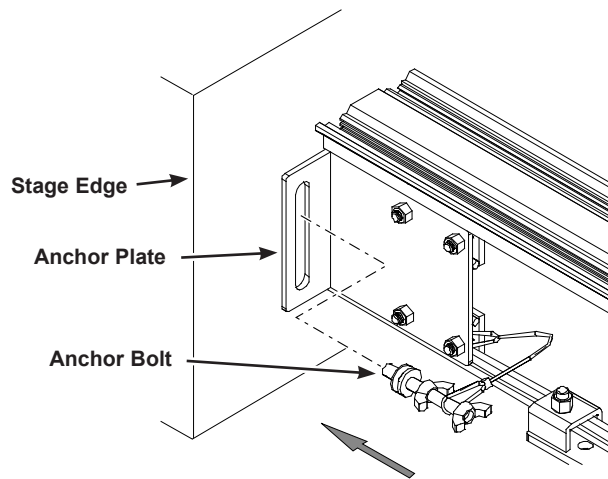

**Attaching Main Beam to Stage Edge**

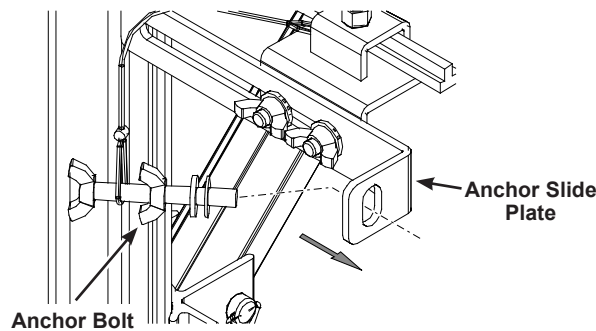

**Attaching the Main Beam to the Audience Wall**

*Audience wall is not shown*

## Installation (continued)

### Assemble First Bay

1. Attach columns to the adjacent main beam as described in the *Install First Main Beam* sub-section. Make sure that the letters on the beam and columns match.
2. Pin the main beam diagonal braces as described in the *Install First Main Beam* sub-section.
3. Tilt the column and beam upward, aligning the column feet with the floor markings.
4. Install the pit filler bolts — **do not tighten**.
5. Install the cross beams between the two main beams by inserting the cross beam pins into the cross beam sockets.

#### **⚠ WARNING**

*To avoid injury, two people must always place the main beams into the pit and install the cross beams.*

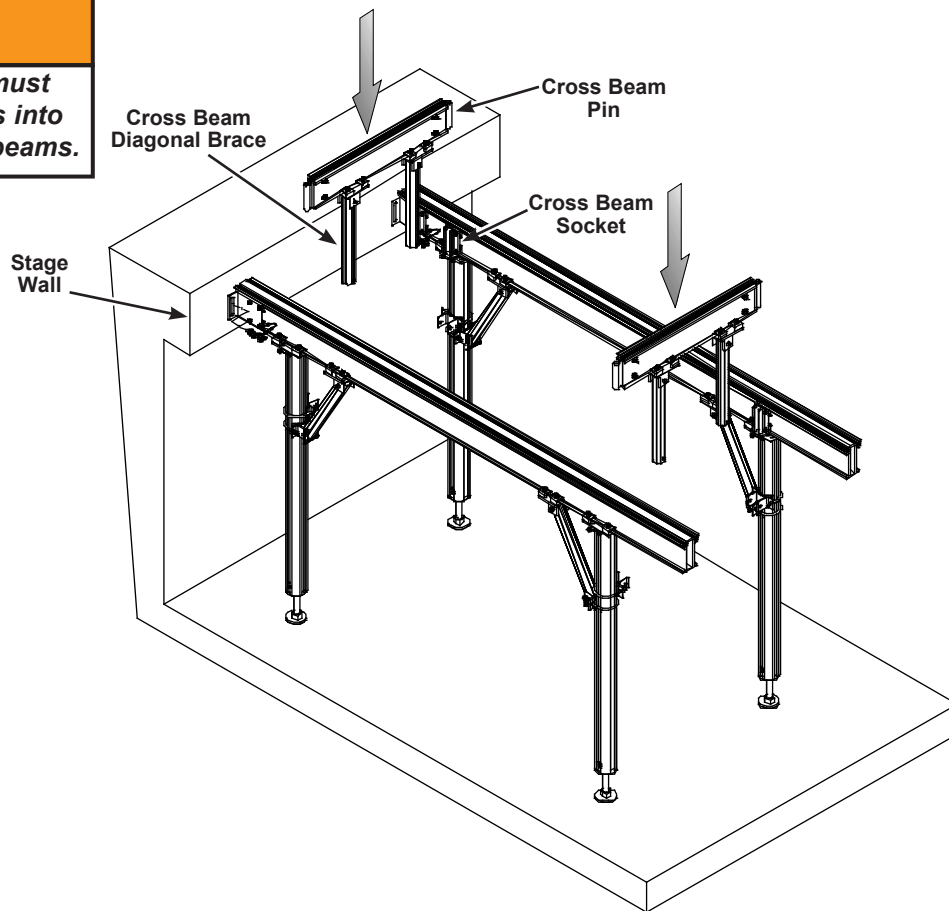

#### **⚠ WARNING**

*Components must be connected as specified in these instructions.*

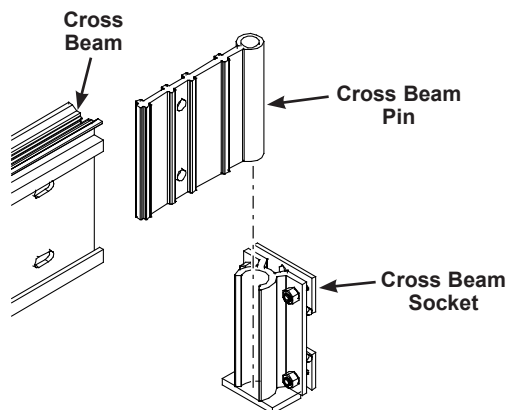

## Installation (continued)

### Assemble First Bay (continued)

- Assemble the lower end of the cross beam braces to the columns by inserting the tab lock pin through the hole in the column brace bracket and the hole in the cross brace.

#### **⚠ WARNING**

**Components must be connected as specified in these instructions.**

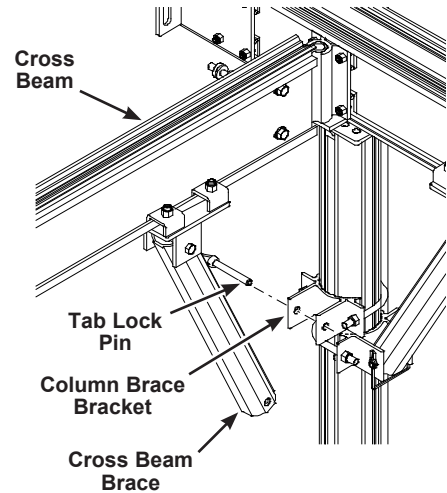

- Starting at the stage edge, set the decks onto the main beams. Make sure that the lock down nodes on the bottom of the decks fit into the channels on the main beams.

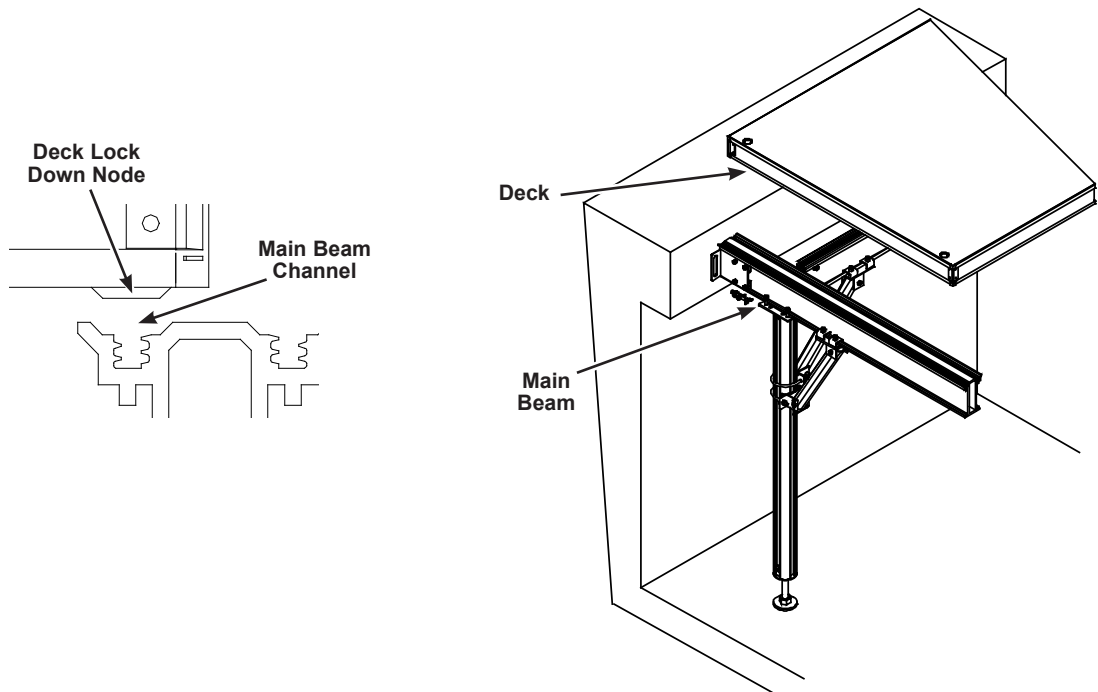



## Installation (continued)

### Assemble First Bay (continued)

- Lock the deck to the main beam by inserting the 1/4" t-handle hex tool into a lockdown cap. While pressing the hex tool downward, turn it clockwise until the fastener is finger tight.

Only turn the lockdown cap using the center hex and do not overtighten.

#### NOTICE

Each deck is numbered. Refer to the Owner's Layout Drawing for the proper deck placement.

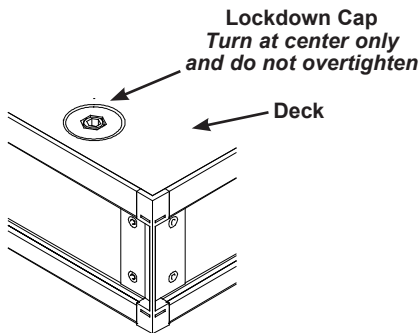

Press downward and turn clockwise until the screw is finger tight

Deck with the lock down node engaged with the beam channel

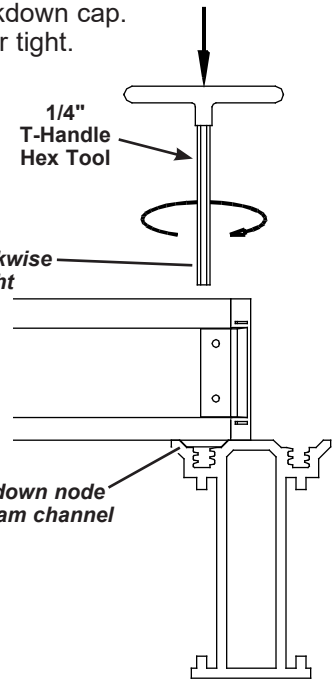

- To keep the edges of adjacent decks aligned and help prevent trip hazards, install alignment clips along the span of the first deck.

Snap a clip onto the deck edging approximately 1/3 of the way in from each deck end as shown.

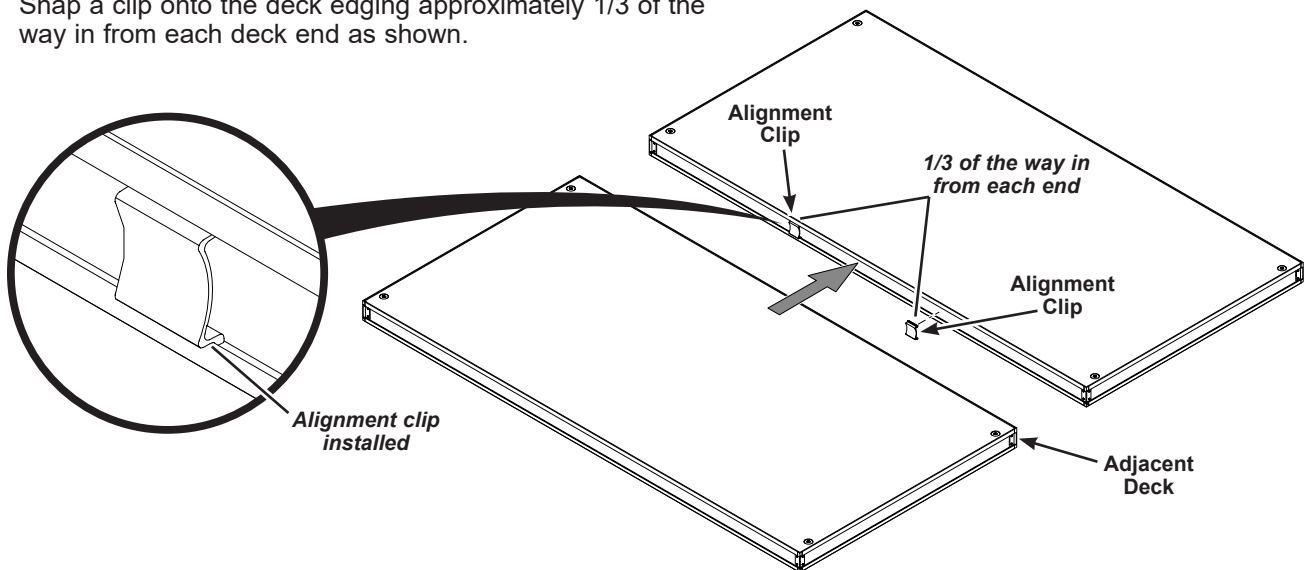

### Continue Adding Bays

- Continue adding bays to the first bay, following the instructions in the *Assemble First Bay* sub-section.
- Tighten the beam anchors at the stage edge and the audience wall.

### Install Accessories

- Refer to the Owner's Drawing Installation Procedure to install any accessories that may be included with the pit filler.

# Disassembly

## Disassemble Accessories

1. Remove any accessories, such as back closures, drapery, etc., by reversing their installation procedure.

## Disassemble Decks

1. Unlock all of the decks by inserting the 1/4" t-handle hex tool into each lockdown cap and turning it counterclockwise until the lockdown screw pops up.

It may be necessary to vacuum away any debris that might interfere with inserting hex tool.

2. Remove each deck and store it (on carts, if supplied).  
If alignment clips were used, remove and store them.

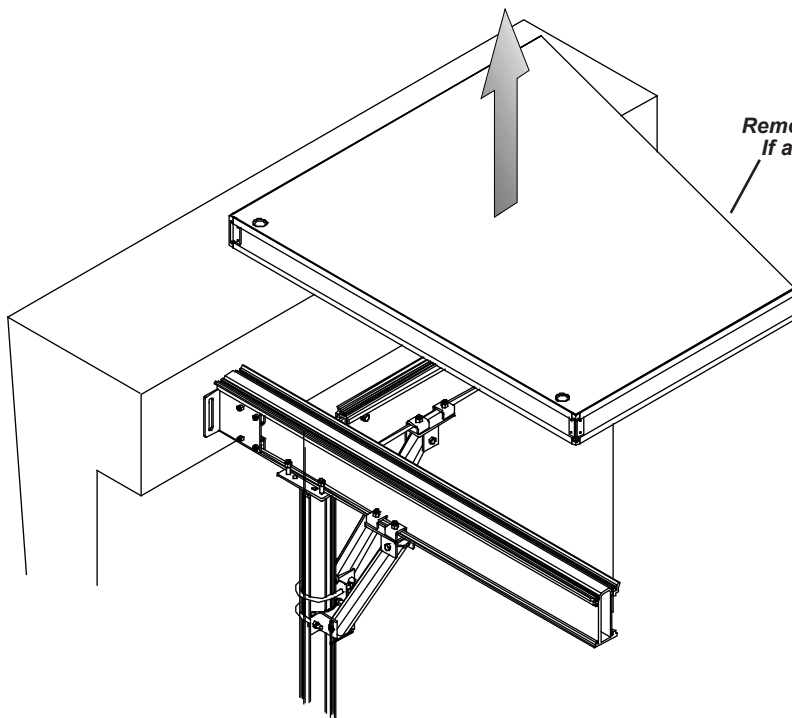
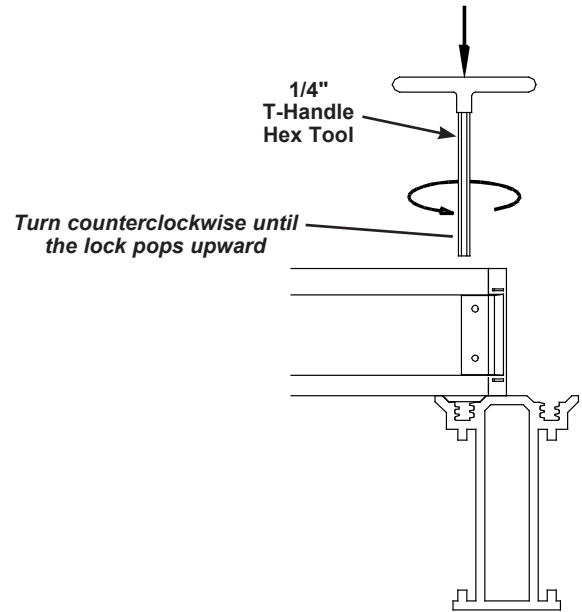

## Disassembly (continued)

### Disconnect Cross Beam Diagonal From Columns

1. Disconnect the lower end of the cross beam diagonal braces from the columns by removing the tab lock pin from the hole in the column brace bracket and the hole in the diagonal.

#### NOTICE

*Do not remove the bolts that connect the diagonals to the cross beams.*

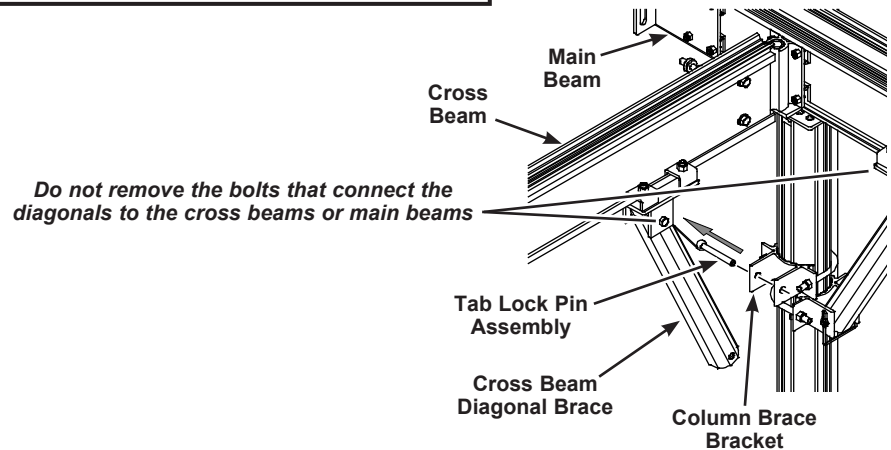

### Loosen Main Beam Anchors

1. Loosen, but do not remove, the main beam pit filler anchor bolt from the stage edge or audience wall. Removal of the pit filler anchor bolt will cause the main beams to fall which may cause serious injury and damage.

#### WARNING

*To avoid injury, do not remove the pit filler anchor bolts.*

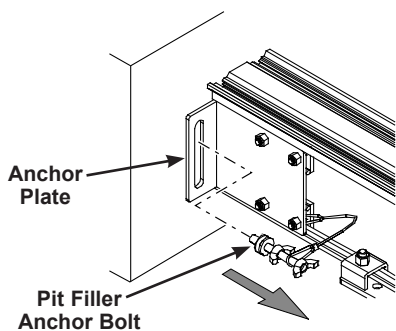

Stage Edge Assembly

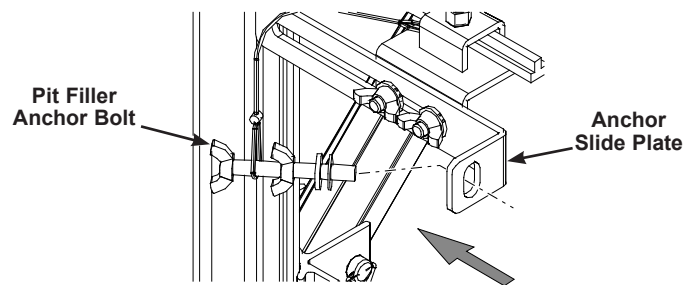

Audience Wall Assembly

## Disassembly (continued)

### Disassemble the Understructure

1. Remove the cross beams and store (on storage cart, if supplied).

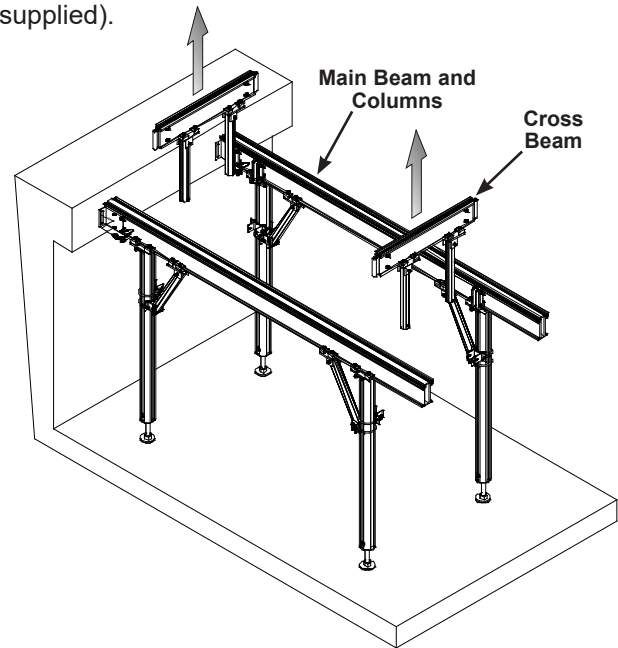

2. With two people working together, hold the main beam and columns in place and remove the main beam anchor bolts from the stage edge or audience wall.
3. With two people, carefully lay the main beam and columns onto the pit floor.
4. Detach the main beam diagonal braces from the columns by removing each tab lock pin from the column brace bracket and brace. Leave the main beam diagonal braces bolted to the main beam.
5. Unpin each column from the main beam.
6. Store the main beam and columns (on storage cart, if supplied).
7. Continue these steps until the pit filler is completely disassembled.

### **⚠ WARNING**

*To avoid injury, two people must always lower the column/beam assemblies onto the pit floor.*

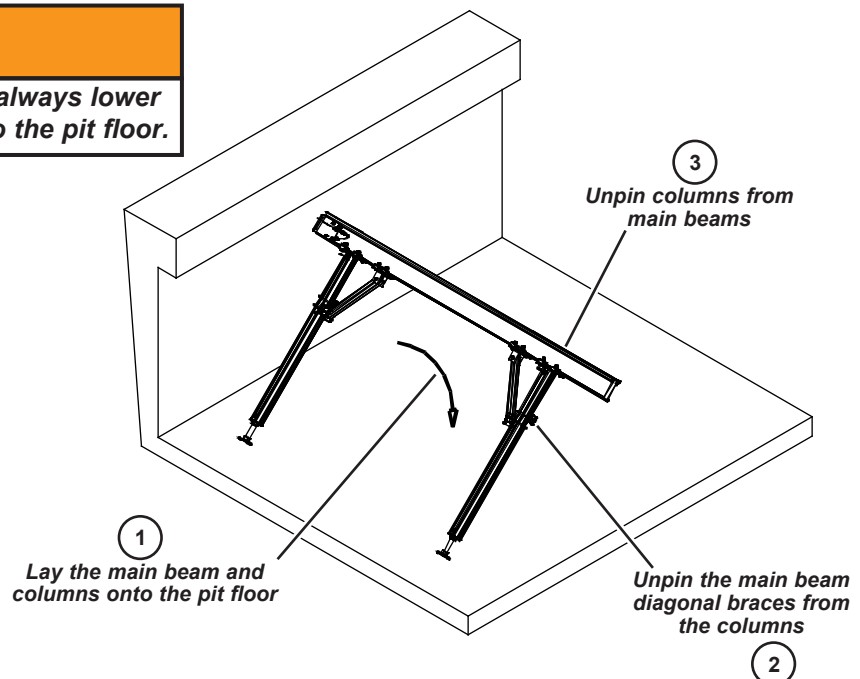

# Transport and Storage

## Main Beam/Column/Cross Beam Storage Cart

### CAUTION

Load the bottom racks first.  
Always balance the load on the cart.

### CAUTION

Always lock the casters when loading and unloading the cart.

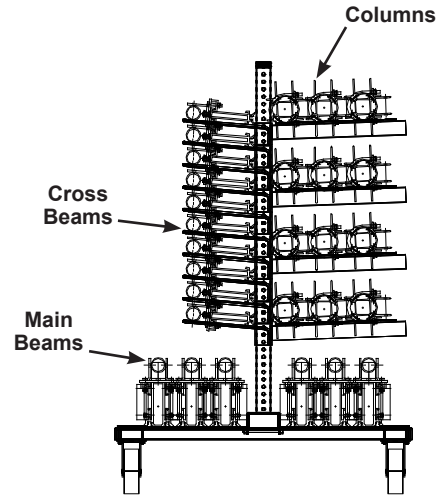
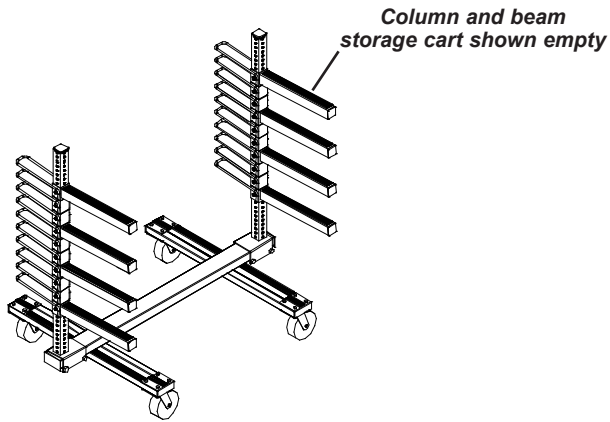

## Deck Storage Cart

### CAUTION

Always lock the casters when loading and unloading the cart.

### CAUTION

Always secure the decks to the cart so that they cannot fall or slide off the cart.

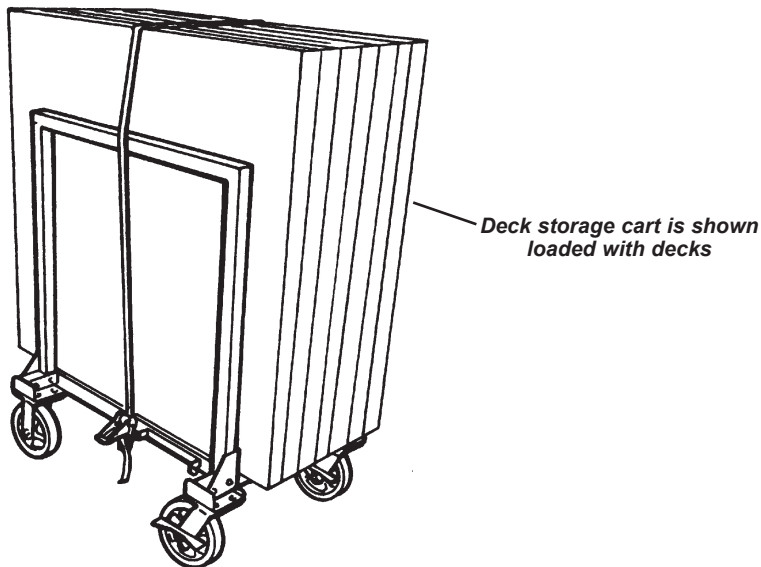

# Maintenance

---

## Decks

1. Keep the deck surfaces clean and dry.
2. Clean with a broom, brush, or damp mop (Never saturate the hardboard surface).
3. The hardboard surface can be painted with any paint suitable for flooring.  
*PPG Wrought Iron Breakthrough Acrylic is the standard top coat.*  
*Allow seven days to fully cure. Avoid getting paint into lockdowns and down edges between decks.*

### NOTICE

**The deck edging cannot be painted.**

4. **Do not** use oil-based cleaning products or stains on the hardboard surface.
5. **Do not** wax or polish the hardboard surface.

## Drapery Closures

1. Drapery sections may be washed or dry-cleaned.
2. Drapery sections are attached with hook and loop strips, to allow easy removal for cleaning.
  - Machine-wash at 120°F or lower using a mild detergent. Remove immediately after the wash cycle completes.
  - Tumble-dry at *permanent press* (maximum 120°F or a lower temperature setting) for 20 to 30 minutes. Remove and hang immediately to prevent wrinkling. Excessive heat or drying time will detract from the permanent-press characteristics of the fabric.
  - Little or no ironing is required.
  - Dry-clean using the Stoddard Method only at temperatures not over 120°F. Remove and hang immediately.

## Other Preventive Maintenance

1. Inspect and tighten all bolts on the beams, cross beams, and columns every six months.
2. Inspect all lockdown assemblies on the decks once every six months for proper function. Replace any lockdown assembly immediately if it does not function correctly.
3. Replace any worn, bent, or broken parts promptly to prevent injury. Contact Wenger Corporation for information regarding replacement.

# Replacement Parts

## Deck

Item	Qty	Description
1	4	Lockdown Sleeve
2	4	Lockdown Cap
3	4	Lockdown Screw
4	4	5/16-18 x 3/4" Socket Capscrew
5	4	0.720 Dia x 1" Compression Spring
6	1	1/4" T-Handle Hex Tool
7	2	Mid Span Deck Alignment Clip

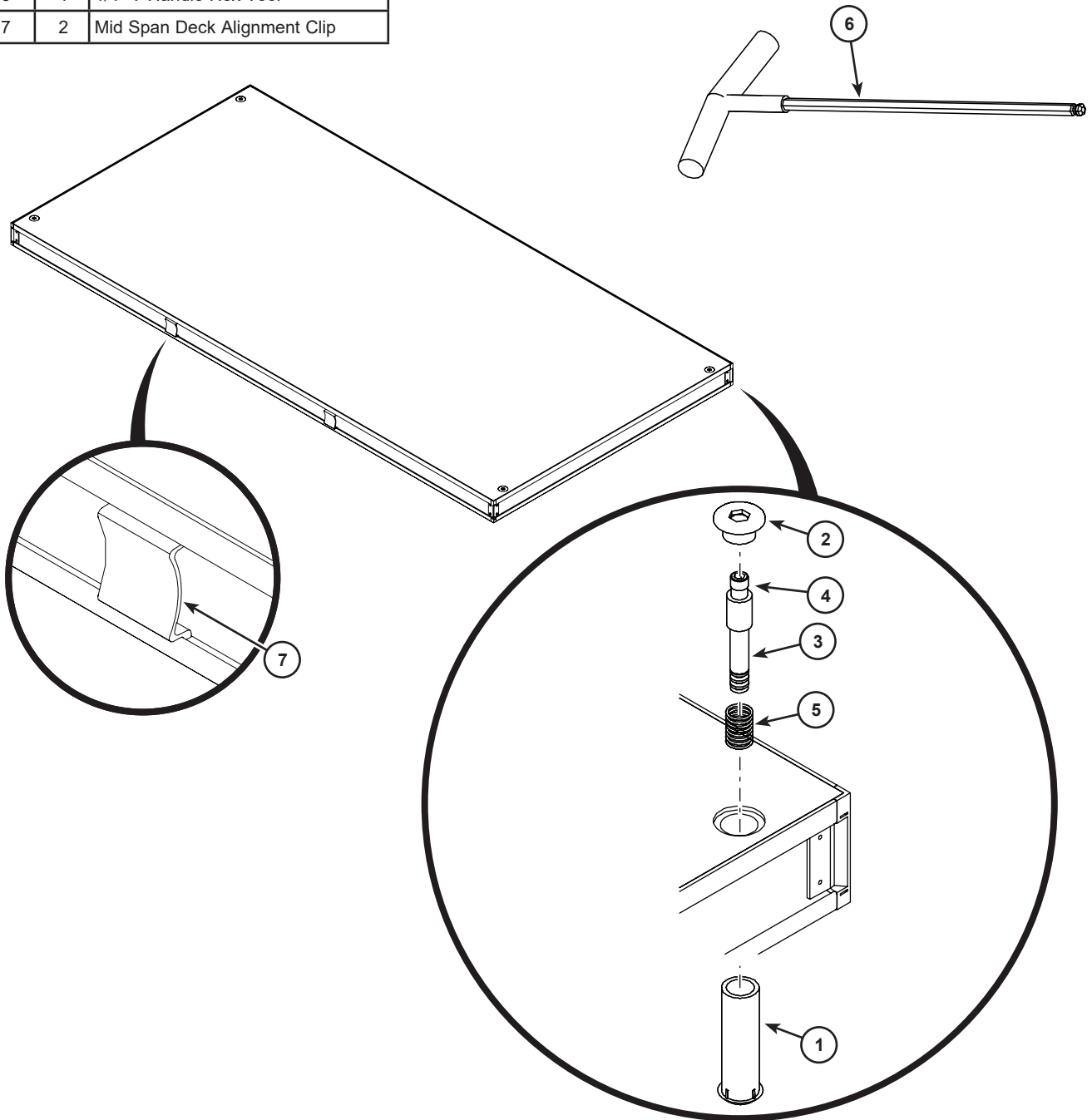

# Replacement Parts (continued)

## Column Bracket

Item	Qty	Description
1	1	Column Bracket Weldment
2	4	Column Bracket Clip
3	4	3/8-16 x 1-3/4" Capscrew
4	4	3/8-16 Lock Nut
5	1	Lanyard
6	1	3/8" x 3-1/2" Snap Lock Pin

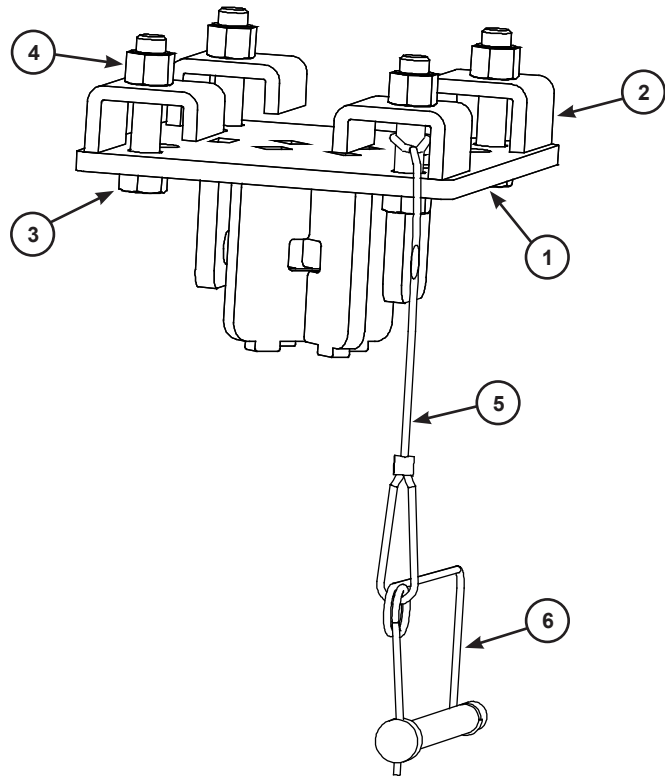
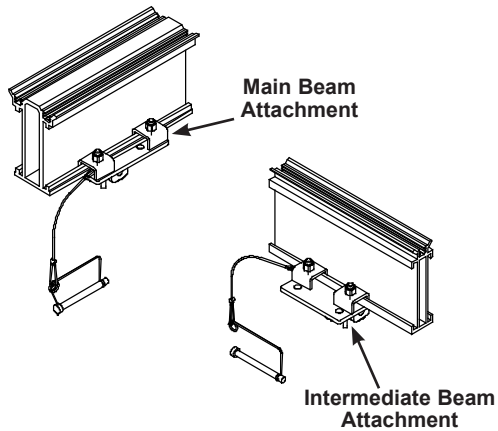

## Beam Brace Bracket

Item	Qty	Description
1	1	Brace Bracket Base Plate
2	1	U-Bracket Base
3	4	Column Bracket Clip
4	1	1/2-13 Jam Lock Nut
5	1	3/8-16 x 3" Capscrew
6	4	3/8-16 x 1-3/4" Capscrew
7	5	3/8-16 Nylon Lock Nut

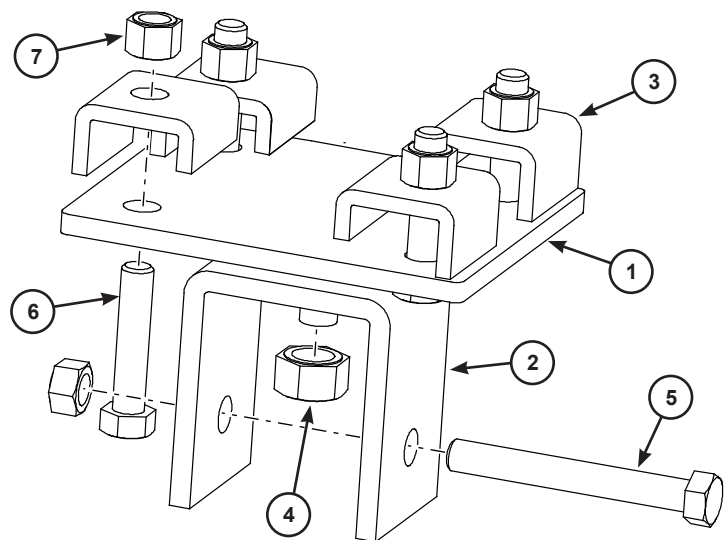
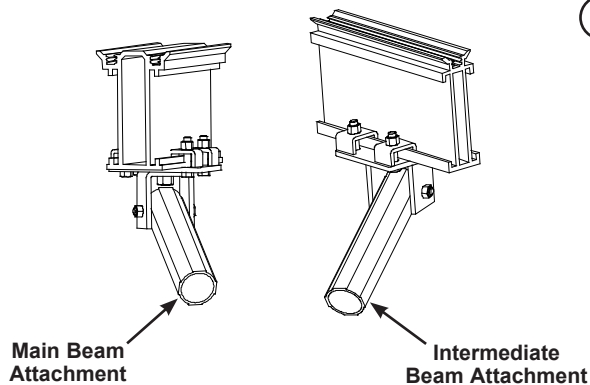



# Replacement Parts (continued)

## Column Foot

Item	Qty	Description
1	1	Leveling Foot Assembly
2	1	Column Foot Insert Weldment
3	2	1/4-20 x 3/4" Self-tapping Screw

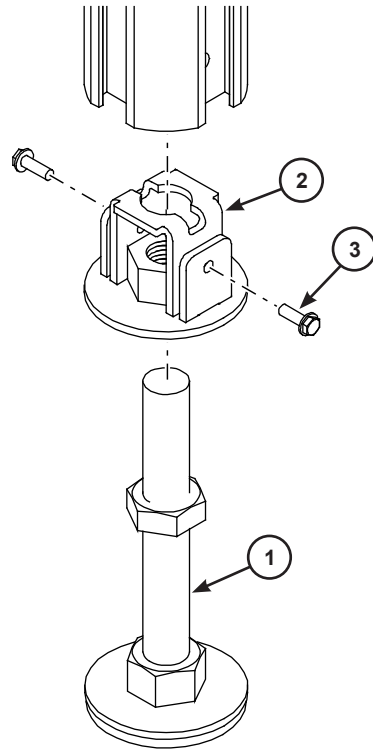

## Column Brace Bracket

Item	Qty	Description
1	1	Extrusion, Column Brace Bracket
2	1	3/8-16 x 4-1/8" U-Bolt
3	2	3/8-18 Nylon Lock Nut
4	1	Nylon Lanyard
5	1	3/8 Dia x 2-3/4" Tab Lock Pin

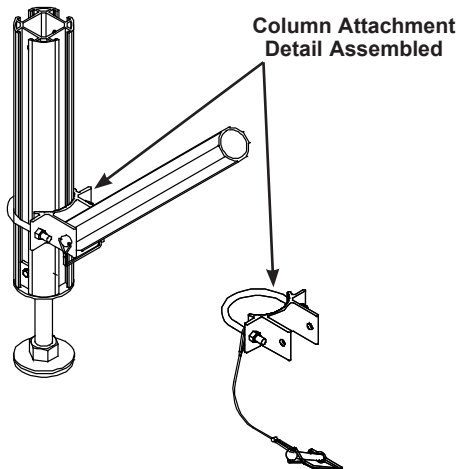
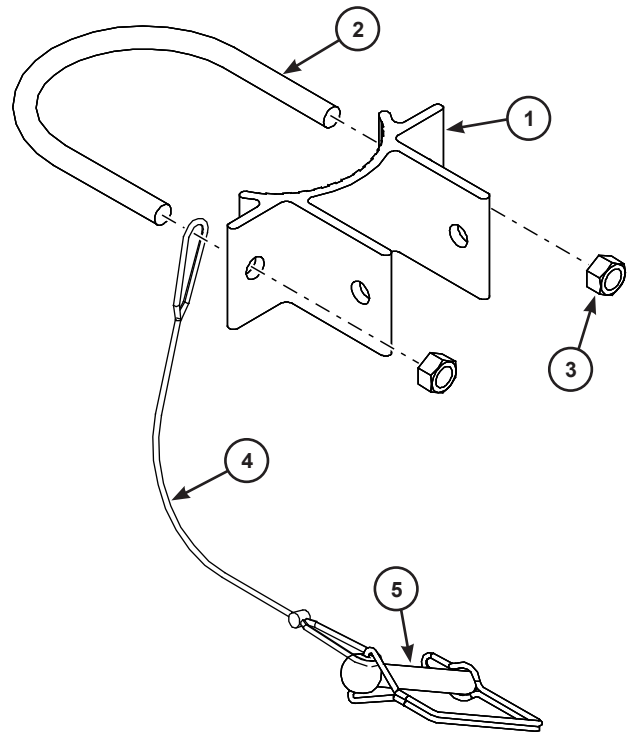

# Replacement Parts (continued)

## Cross Beam

Item	Qty	Description
1	2	Cross Beam Pin
2	4	3/8-16 x 1-1/2" Capscrew
3	8	3/8x1-1/4" Flat Washer
4	4	3/8-16 Nylon Lock Nut

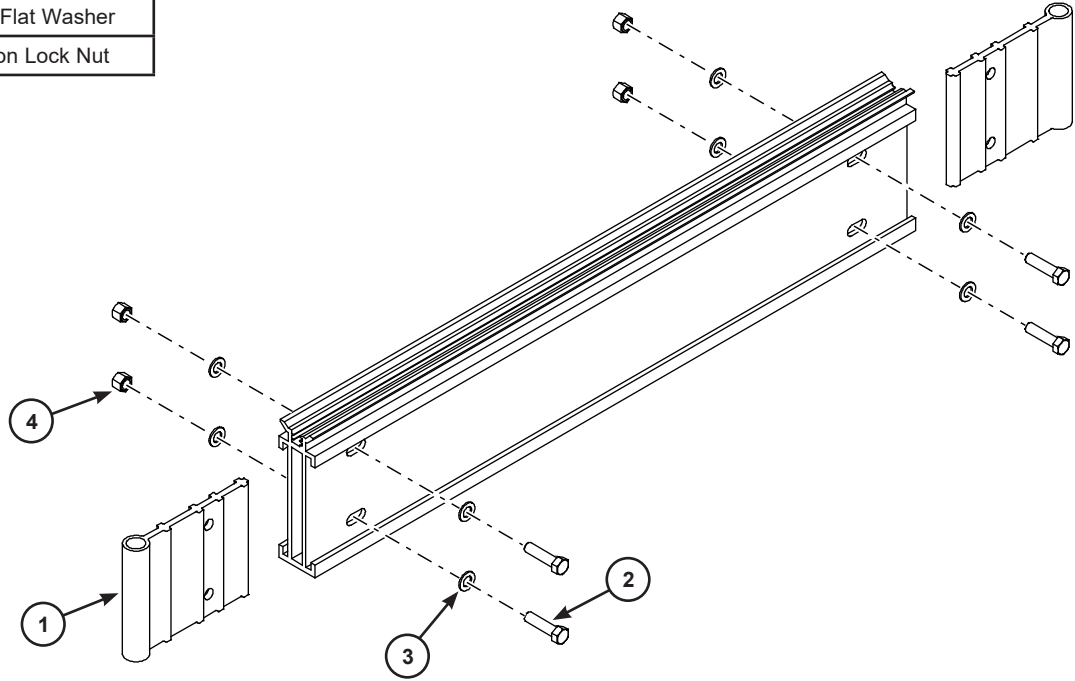

## Cross Beam Socket

Item	Qty	Description
1	1	Cross Beam Socket
2	2	Stud Clip
3	4	5/16-18 Nylon Lock Nut

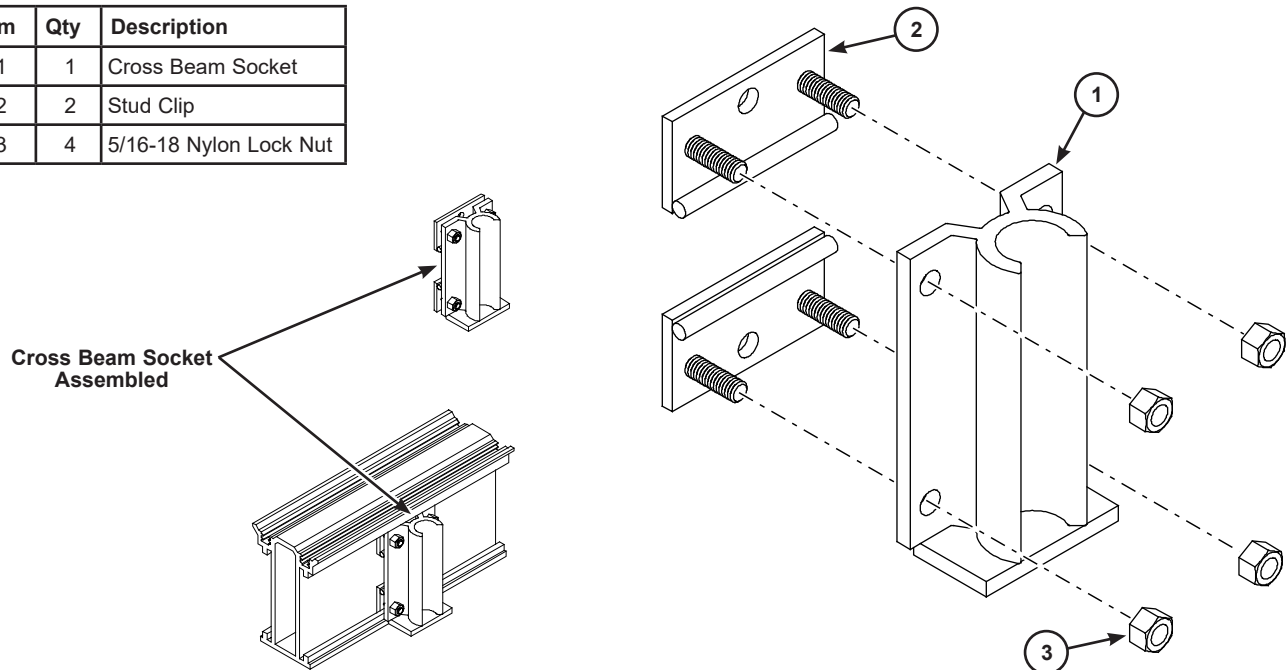

# Replacement Parts (continued)

## Anchor Bracket, Stage Edge

Item	Qty	Description
1	1	Stage Edge Anchor Bracket
2	2	Stud Clip
3	4	5/16-18 Nylon Lock Nut
4	1	Nylon Lanyard
5	1	Pit Filler Anchor Bolt

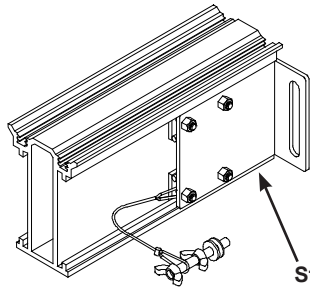

Stage Edge Anchor Bracket  
Shown attached to main beam

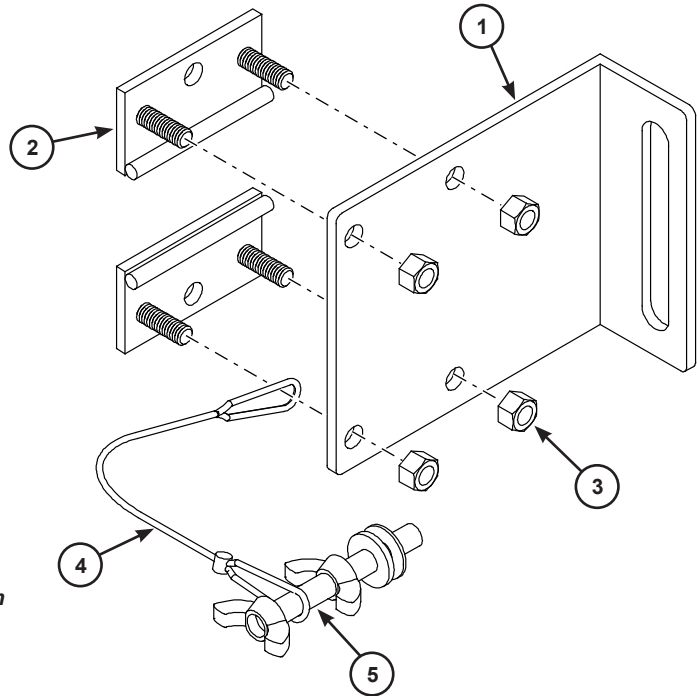

## Anchor Bracket, Audience Wall

Item	Qty	Description
1	1	Audience Wall Anchor Bracket
2	2	Bracket Clips
3	2	3/8-16 x 1-3/4" Capscrew
4	2	3/8-16 Nylon Lock Nut
5	1	Nylon Lanyard
6	1	Pit Filler Anchor Bolt
7	1	Anchor Slide Bracket
8	1	3/8" Lock Washer
9	1	5/16" Flat Washer
10	2	3/8-16 Wing Nut

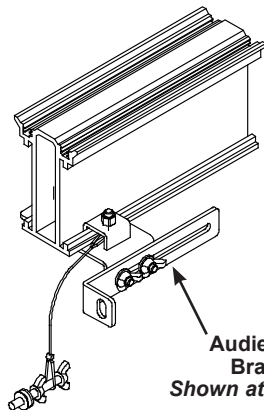

Audience Wall Anchor  
Bracket Assembly  
Shown attached to main beam

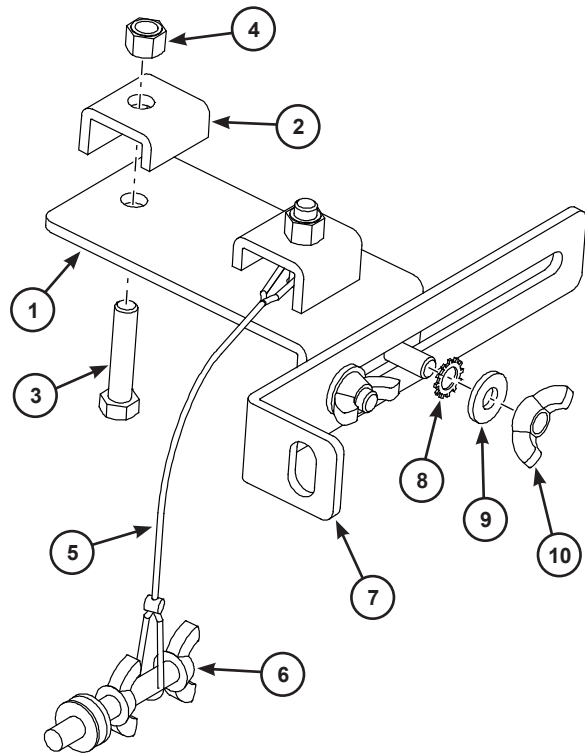

# Replacement Parts (continued)

## Storage/Transport Cart

Item	Qty	Description
1	1	Cart Base Weldment
2	2	Cart Upright Weldment
3	16	5/16-18 x 2-1/4" Capscrew
4	16	5/16-18 Nylon Insert Lock Nut
5	4	6" Dia Swivel Caster (650 lb capacity)
6	4	1/2-13 x 5" Capscrew
7	4	1/2-13 Nylon Insert Lock Nut
8	20	3/8-16 x 2-3/4" Capscrew
9	20	3/8-16 Nylon Insert Lock Nut
10	14	Cart Shelf Beam Inter. Weldment
11	6	Cart Shelf Column Beam Inter. Weldment
12	8	14-18 x 2" Square Plug

